

Recommended PC board pattern  
(TOP VIEW)

SPECIFICATIONS

- 1.CURRENT RATING: 1.4A .
- 2.VOLTAGE RATING 300 VDC.
- 3.OPERATING TEMPERATURE RANGE:-55°C TO +125°C
- 4.HIGH-SPEED CHANNEL PERFORMANCE 56 Gbps

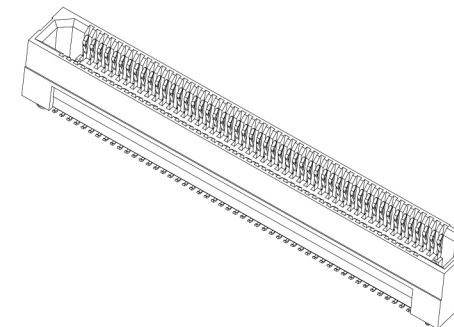
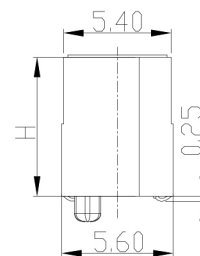
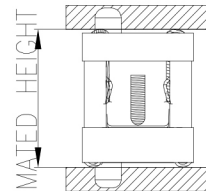

HEIGHT	H
5.00	5.10
7.00	7.00
9.00	9.00

POSITION	A	B	C	D
10	10.00	8.32	3.20	6.80
20	14.00	12.32	7.20	10.80
22	14.80	13.12	8.00	11.60
24	15.60	13.92	8.80	12.40
26	16.40	14.72	9.60	13.20
30	18.00	16.32	11.20	14.80
40	22.00	20.32	15.20	18.80
50	26.00	24.32	19.20	22.80
60	30.00	28.32	23.20	26.80
80	38.00	36.32	31.20	34.80
100	46.00	44.32	39.20	42.80
120	54.00	52.32	47.20	50.80
140	62.00	60.32	55.20	58.80
150	66.00	64.32	59.20	62.80
200	86.00	84.32	79.20	82.00

ERF8 LEAD STYLE	MATED HEIGHT			
	ERM8 LEAD STYLE			
5.00	2.00	5.00	8.00	9.00
7.00	7.00	10.00	13.00	14.00
9.00	9.00	12.00	15.00	16.00
	11.00	14.00	17.00	18.00

**WORLDPO** 沃德披欧连接器 深圳市沃德披欧精密器件有限公司  
Shenzhen WorldPO Precision Device Co., Ltd.



修订 SER	修改摘要 REVISION DESCRIPTION	签名 SIGNATURE	日期 DATE	版本 (REV) A	一般公差 GENERAL TOLERANCE .X ±0.35 .XX ±0.25 .XXX ±0.10 ANGLES ±1°	制图 (DR): Jerry 2020.07.04	品名(TITLE): ERF8 0.8 PITCH BTB SOCKET	审核 (CHKD): Tong 2020.07.04	料号(PART NO): WERF8-2X XXHXX X DV	比例(SCALE): 1:1	单位(UNITS): mm	张数(SHEET): 1 OF 1	图幅(SIZE): A4
-----------	------------------------------	-----------------	------------	------------------	--	---------------------------------	---	----------------------------------	-------------------------------------	-------------------	------------------	----------------------	-----------------